



# 19 Leybourne Road

, Strood, ME2 3QF

**Offers Around £425,000**



Virtual tour available. EXTENDED\*\*FOUR BEDROOMS\*\*FAMILY BATHROOM\*\*WET ROOM\*\*PARKING FOR TWO CARS\*\*NO CHAIN!!

This four bedroom extended semi detached house on Leybourne Road, is available to view and is offered to the market with NO FORWARD CHAIN.

The current owners have added a great size ground floor extension to the home providing an additional sitting room to the rear, a fourth bedroom, a wet room and office space.

The eat in kitchen/breakfast room with a utility, runs across the whole width of the house and then there a spacious formal lounge to the front. To there first floor there are three bedrooms and a family bathroom. Added benefits include gas central heating, double glazed windows, a drive way for two cars and a low maintenance rear garden,

Leybourne Road is ideally situated close to many amenities including schools for all ages, the town centre and links to the A2/M2. Call now to book your appointment to view. Council Tax Band C.



- entrance hall
- lounge
- kitchen breakfast room
- utility room
- sitting room
- bedroom
- wet room
- study area
- stairs /landing
- bedroom
- bedroom
- bedroom
- garden
- drive

## Area Map



## Floor Plans

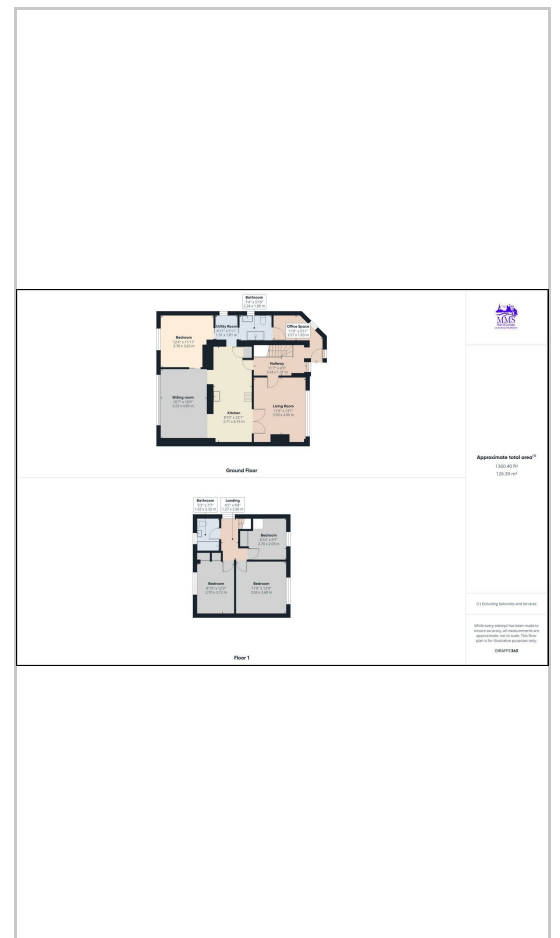

## Energy Efficiency Graph



These particulars, whilst believed to be accurate are set out as a general outline only for guidance and do not constitute any part of an offer or contract. Intending purchasers should not rely on them as statements of representation of fact, but must satisfy themselves by inspection or otherwise as to their accuracy. No person in this firm's employment has the authority to make or give any representation or warranty in respect of the property.